

SEZIONE A-A

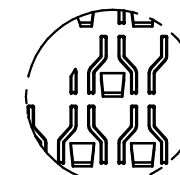

DETTAGLIO C



DETTAGLIO D

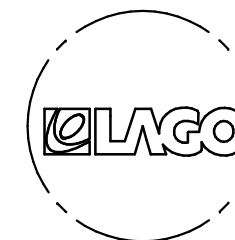

DETTAGLIO E

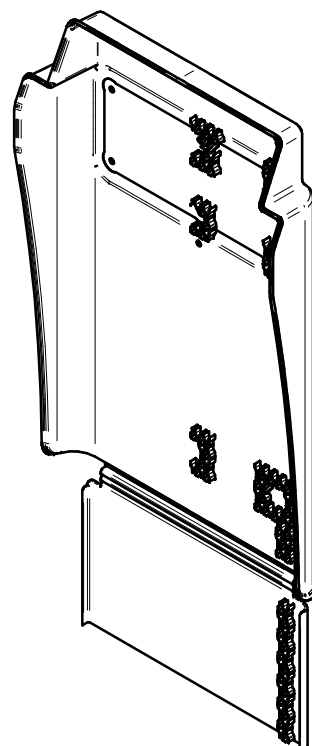
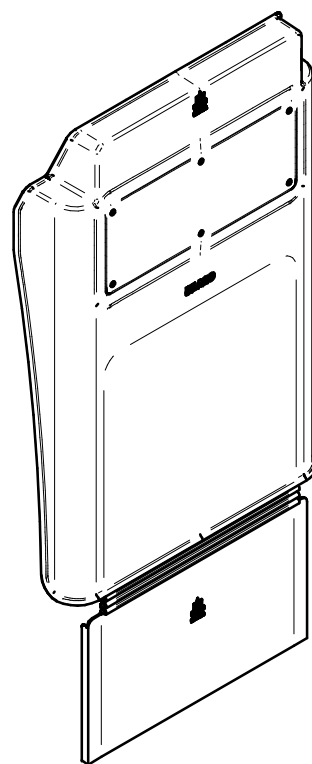
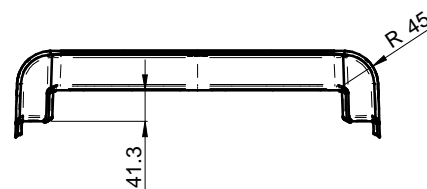

ACCURACY				REVIEW	N°2	DATE	DESCRIPTION	DRAFTSMAN	
LINEAR DIMENSIONS									N°1
±0.1	from 6 to 30	±0.2	from 30 to 120	±0.3	from 120 to 315	±0.5	Aggiunta spessore (nervatura) di rinforzo sopra la cerniera per contrastare la deformazione del pezzo (studio 1702081)	Manuel Pillan	
±0.8	from 315 to 1000	±1.2	from 1000 to 2000	±2.0	from 2000 to 4000	±3.0	Portato i 6 fori a 8,5mm e tolti gli esagoni di antigiro	Manuel Pillan	
ANGULAR DIMENSIONS				MATERIAL		TREATMENT		DRAFTSMAN	
±1°	from 6 to 30	±30'	from 30 to 120	±20'	from 120 to 315	±10'	PP	Manuel Pillan	
<p>Lago Accessori srl via 1°Maggio 20, 35014 Fontaniva (Pd) Italy Tel: +39 049 5940932 Fax: +39 049 5940599 www.lagoaccessori.net info@lagoaccessori.net</p>				SCALE		CREATION DATE		SET	
				1 : 10		21/12/2016		DRAWING CODE	
<p>SHEET 1/1</p>				DESCRIPTION		PAR.735X480 KOMPLEET KOMMA 260			
				CODE AND DESCRIPTION OF FINISHED PRODUCT					