

A

B

C

D

E

F

IF IN DOUBT ASK

IF IN DOUBT ASK

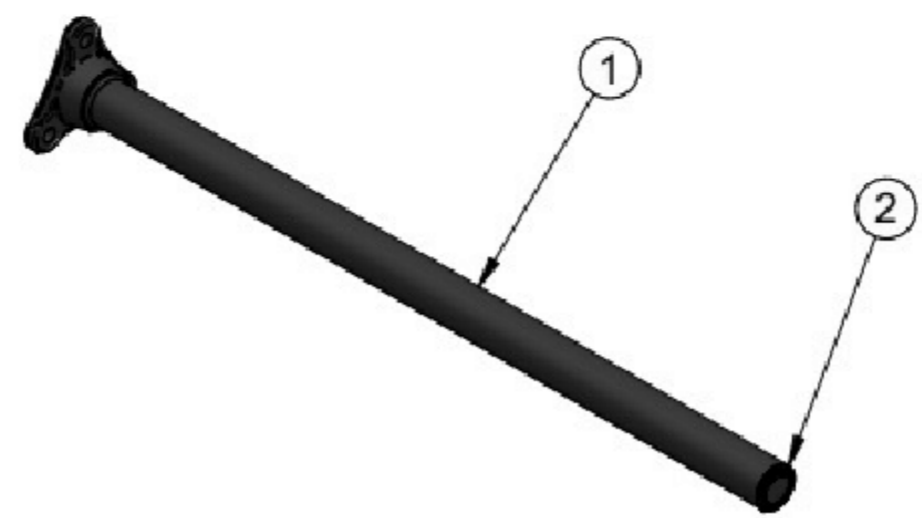
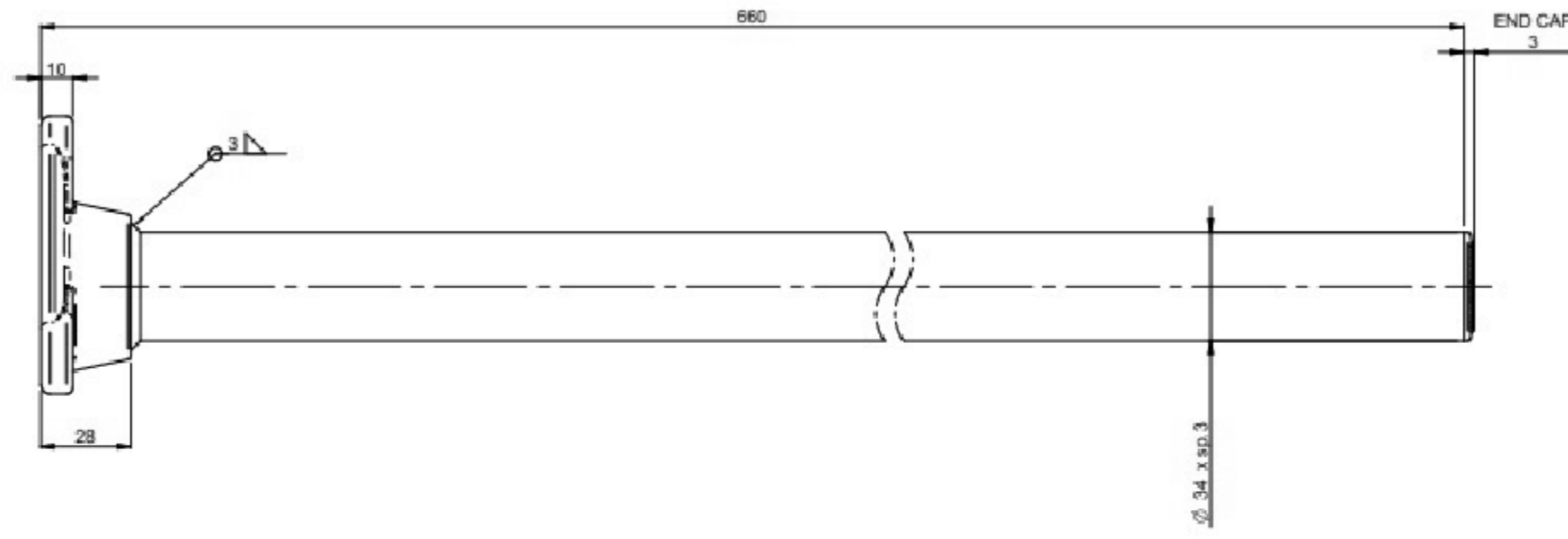

ZONE	REV.	DESCRIPTION	DATE	APPROVED
F3, F7	2	NOTES AND FINISH CORRECTED	11/06/2024	L.B.H
	1	VALIDATION COMPLETE	08/02/2024	AP

REVISIONS

NOTE:
THIS PRODUCT HAS BEEN SALT SPRAY CORROSION TESTED TO 480hrs TO STANDARD ISO 9227

TOLERANCES		SURFACE FINISH 1.6um Ra	
0.5 - 6	= ±0.1mm	FILLET RADII	0.5 TO 1.0
6 - 30	= ±0.2 mm	SQUARENESS	0.05 IN 25
30 - 120	= ±0.3 mm	PARALLELISM	0.05 IN 25
120 - 400	= ±0.5 mm	RUNOUT	0.1
400 - 1000	= ±0.8 mm	ANGLES	±0.5°
1000 - 2000	= ±1.2 mm		
2000 - 4000	= ±2.0 mm		

MATERIAL: S235JR Steel	DRAWN BY: L.B.H	DESCRIPTION: WINGSTAY STRAIGHT 34MM X 660MM BLACK 3 HOLE FIXING		A3
MASS: 1.977	CHECKED BY: U.F	NUMBER: 6688-162001113	REVISION: 2	
FINISH: GALVANISED +BLACK EPOXY	APPROVED BY: A.P	SHEET: 1 of 1		
ORIGINATION DATE: 06/02/2024		SCALE : PROPORTIONAL - DO NOT SCALE REF SCALE 1:2 WHEN PRINTED ON A3		PROJECTION 3rd ANGLE

PROPRIETARY RIGHTS ARE INCLUDED IN THE INFORMATION DISCLOSED HEREIN. NEITHER THIS DOCUMENT NOR ANY INFORMATION DISCLOSED SHALL BE REPRODUCED, USED, TRANSFERRED TO OTHER DOCUMENTS, OR DISCLOSED TO OTHERS FOR ANY PURPOSE INCLUDING MANUFACTURING UNLESS SPECIFICALLY AUTHORISED IN WRITING REMOVE ALL SHARP EDGES AND BURRS PART FINISHING AND MARKING TO CESF001

