

IF IN DOUBT ASK

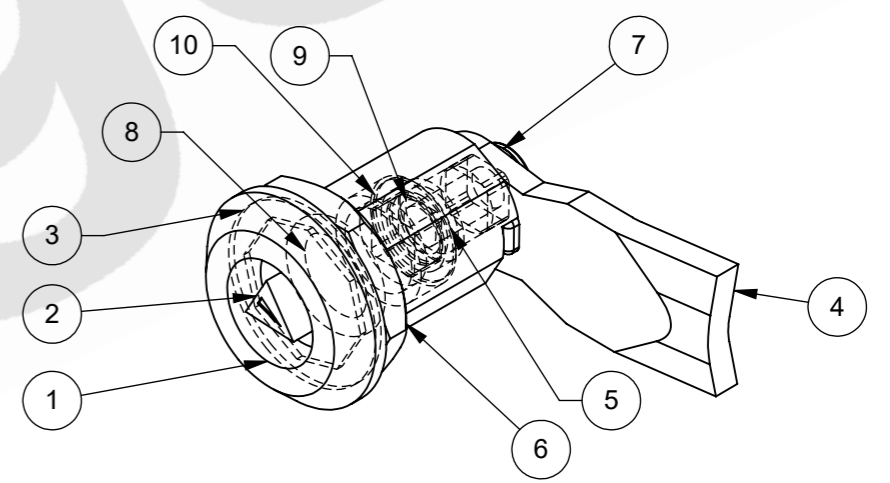
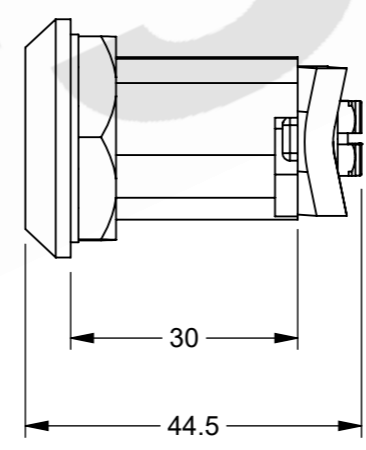
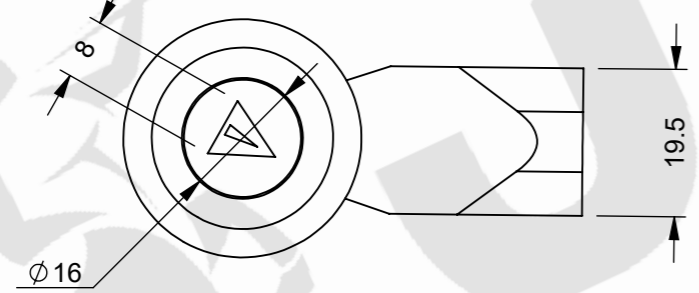
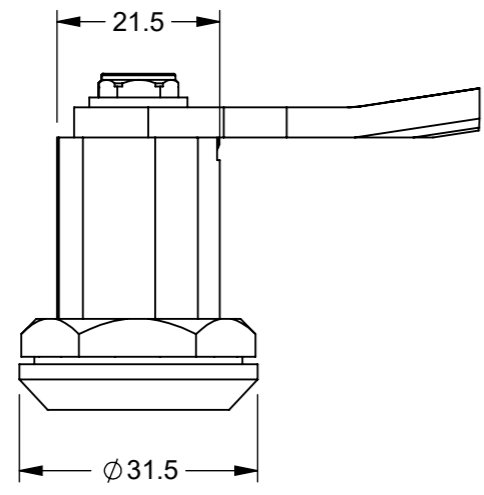

ITEM NO.	PART NUMBER	DESCRIPTION	QTY.
1	5000-830T-1	ZINC DIE-CAST HOUSING - CHROME PLATED	1
2	5000-830T-2	ZINC DIE-CAST SQUARE - CHROME PLATED	1
3	5000-830T-3	RUBBER NBR GASKET	1
4	5000-830T-4	M/STEEL CAM - ZINC PLATED	1
5	5000-830T-5	ZINC DIE-CAST DOUBLE BIT - SELF-COLOUR	1
6	5000-830T-6	ZINC DIE-CAST NUT - SELF-COLOUR	1
7	5000-830T-7	M/STEEL M6 SCREW - ZINC PLATED	1
8	5000-830T-8	RUBBER NBR O RING - BLACK	1
9	5000-830T-9	RUBBER NBR O RING - BLACK	1
10	5000-830T-10	STAINLESS STEEL 304 WASHER	1

ZONE	REV.	DESCRIPTION	DATE	APPROVED
	1	VALIDATION COMPLETE	02/07/2025	C.H

REVISIONS

UNLESS OTHERWISE STATED, ALL DIMENSIONS IN mm	
TOLERANCES	
0.5 - 6	= ±0.1mm
6 - 30	= ±0.2 mm
30 - 120	= ±0.3 mm
120 - 400	= ±0.5 mm
400 - 1000	= ±0.8 mm
1000 - 2000	= ±1.2 mm
2000 - 4000	= ±2.0 mm
SURFACE FINISH 1.6µm Ra	
FILLET RADII 0.5 TO 1.0	
SQUARENESS 0.05 IN 25	
PARALLELISM 0.05 IN 25	
RUNOUT 0.1	
ANGLES ±0.5°	

MATERIAL: SEE TABLE	DRAWN BY: L.B.H		DESCRIPTION: QUARTER TURN LOCK		A3	
MASS: 0.13	CHECKED BY: U.F		NUMBER: 5000-830T	REVISION: 1		SHEET: 1 of 1
FINISH: SEE TABLE	APPROVED BY: C.H		ORIGINATION DATE: 02/07/2025			SCALE: PROPORTIONAL - DO NOT SCALE REF SCALE 1:1 WHEN PRINTED ON A3

PROPRIETARY RIGHTS ARE INCLUDED IN THE INFORMATION DISCLOSED HEREIN. NEITHER THIS DOCUMENT NOR ANY INFORMATION DISCLOSED SHALL BE REPRODUCED, USED, TRANSFERRED TO OTHER DOCUMENTS, OR DISCLOSED TO OTHERS FOR ANY PURPOSE INCLUDING MANUFACTURING UNLESS SPECIFICALLY AUTHORISED IN WRITING. REMOVE ALL SHARP EDGES AND BURRS. PART FINISHING AND MARKING TO CESF001

